

GEA

Ground 158,157ft²
 First 4,863ft²
 Second 5,293ft²
 Total **168,313ft²**

GIA

Ground 155,709ft²
 First 4,434ft²
 Second 4,882ft²
 Total **165,025ft²**

15m CIH
50m Yard depth
17 Dock level doors
1 Double deck level door
4 level access doors
40 HGV / trailer bays
169 Car spaces

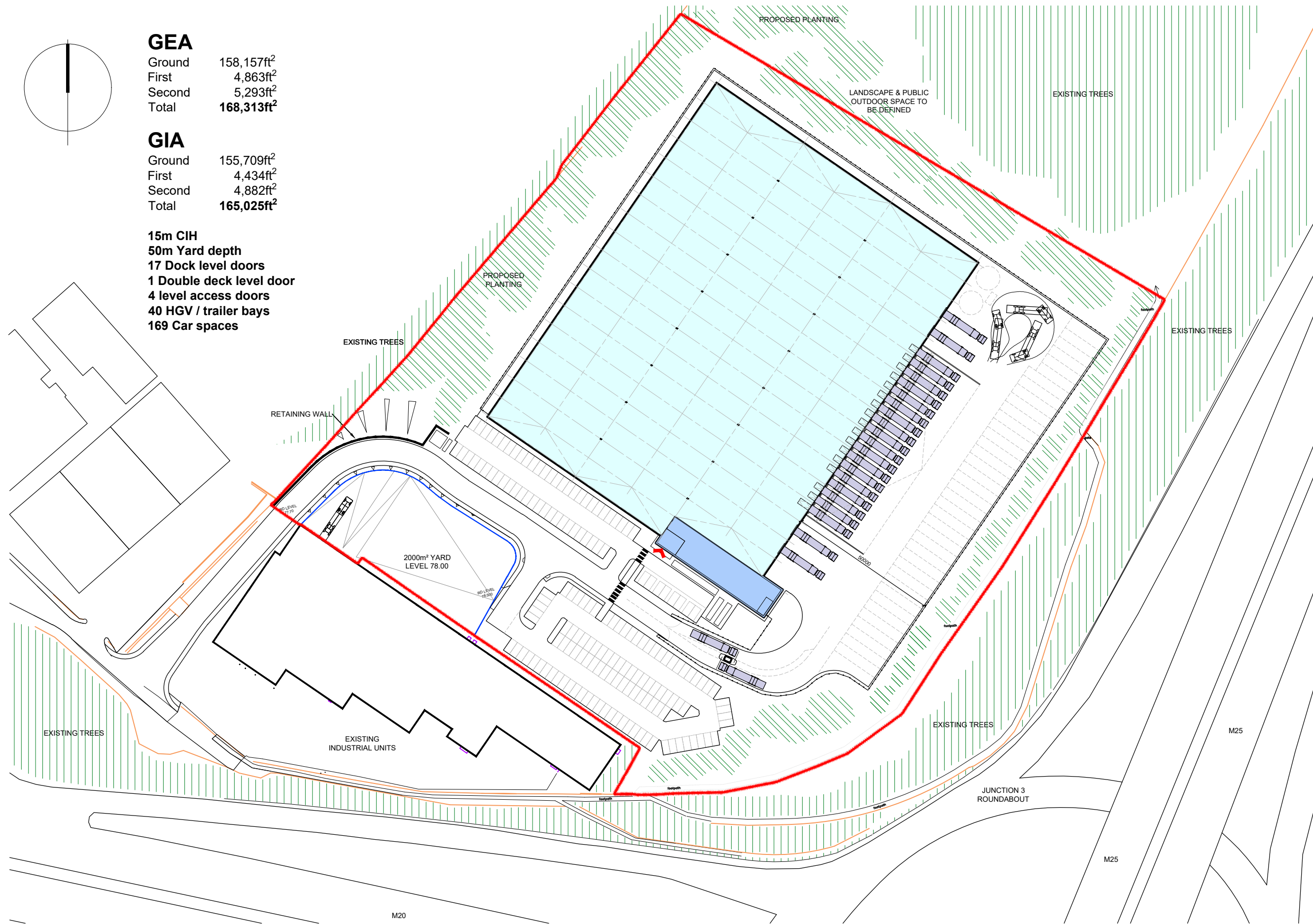

Offices
 Woking
 London
 Milton Keynes
 Warsaw

Architecture
 Planning
 Master Planning
 Urban Design
 Interiors
 Landscape

12 Warren Yard
 Warren Park
 Milton Keynes
 MK12 5NW
 01908 305 246

info@prc-group.com
 www.prc-group.com

Revisions:

Drawn/Chkd: Date:

Figured dimensions only are to be used. All dimensions to be checked onsite. Differences between drawings and between drawings and specification or bills of quantities to be reported to the PRC Group. The copyright of the drawings and designs contained therein remains vested in the PRC Group.

Client: GOYA DEVELOPMENTS
Project: BROOMHILL, SWANLEY
Drawing Title: PROPOSED SITE LAYOUT

Scale @ A3: 1:1250	Checked by: JR	Date: AUG 20
Job No: 11181	Stage: FE	Drawing No: 011
Rev: A	Construction <input type="checkbox"/>	Preliminary <input type="checkbox"/>
Approval <input type="checkbox"/>	Tender <input type="checkbox"/>	Information <input type="checkbox"/>

